

Albor San Miguel de Allende by PRODUCTORA & ESRawe STUDIO

Tapestry Collection by Hilton

2023-05-31

↓ 下方项目标题框内皆可点击查看，请通过公众号、地址、分类器的具体表现查看更多，Copyright©版权所有设计网goodoo，发图转载，禁止以goodoo链接形式进行任何形式转载。

Project Specs

- Design : ESRawe STUDIO PRODUCTORA
- Location : Mexico
- Type : Architecture
- Materials : Stone Clay Wood Metal Ceramic Plant Fabric
- Tags : Guanajuato
- Category : Hospitality Roof Garden Hotels

非常感谢 **PRODUCTORA** 和 **ESRawe Studio** 于goodoo®的分享。更多关于他们：
[PRODUCTORA on goodoo](#), [ESRawe Studio on goodoo](#).
 Appreciation towards **PRODUCTORA & ESRawe Studio** for providing the following description:

位于圣米格尔德阿连德的Albor酒店建筑与周边的自然环境融为一体。酒店自然地呈现在地形之中，与山谷共同构成了美丽的景色。酒店建筑的石质地基灵感源于山脉的内部结构，其外观则有非凡的质感和丰富的色彩。

The architecture of Albor Hotel in San Miguel de Allende effortlessly integrates with the surrounding natural environment. The hotel emerges naturally from the terrain, framing a beautiful view of the valley. The hotel's stone base is inspired by the mountain's interior, featuring a textured and colorful appearance.

▼鸟瞰，Bird's eye view © Clear Bijker

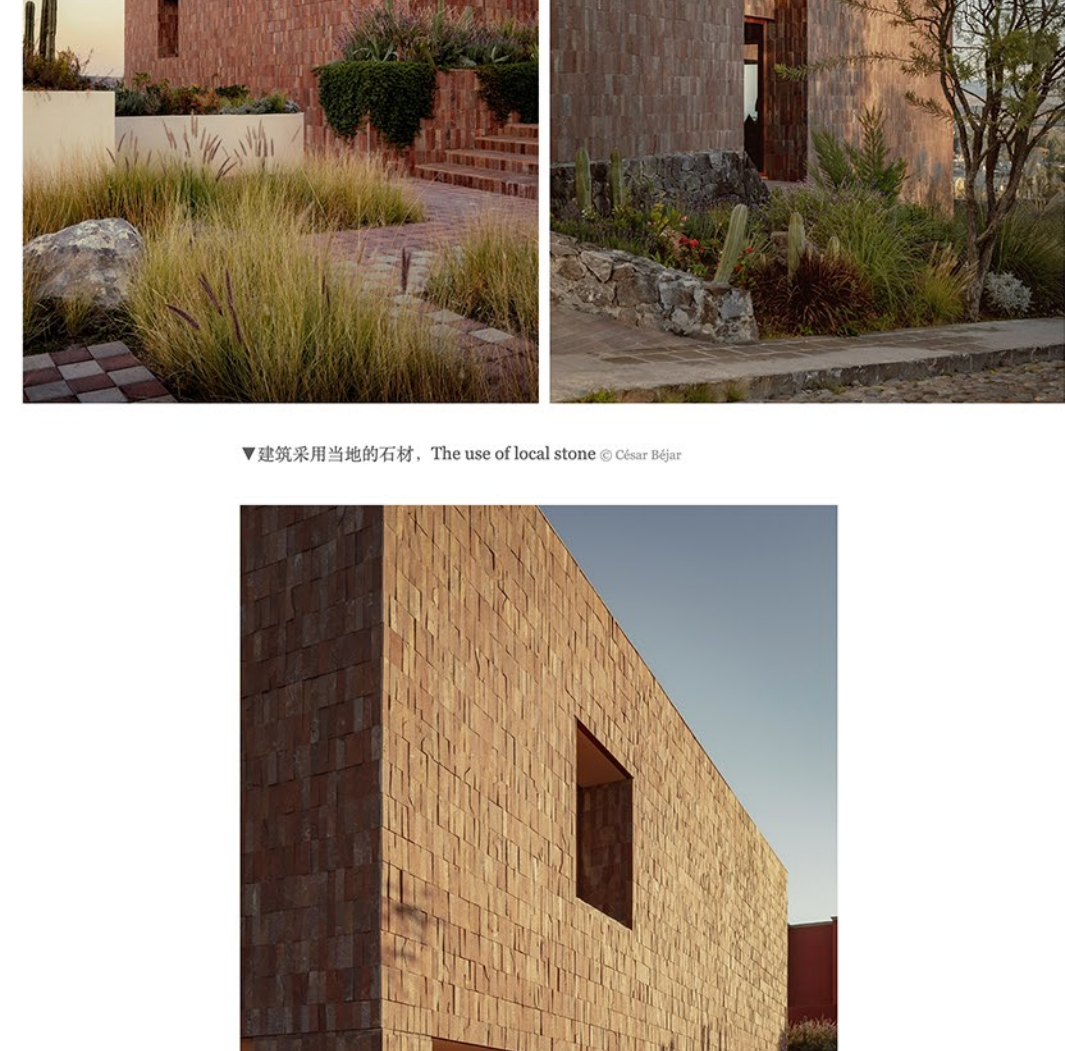

▼与自然相融的建筑，Integrates with the surrounding natural environment © Clear Bijker

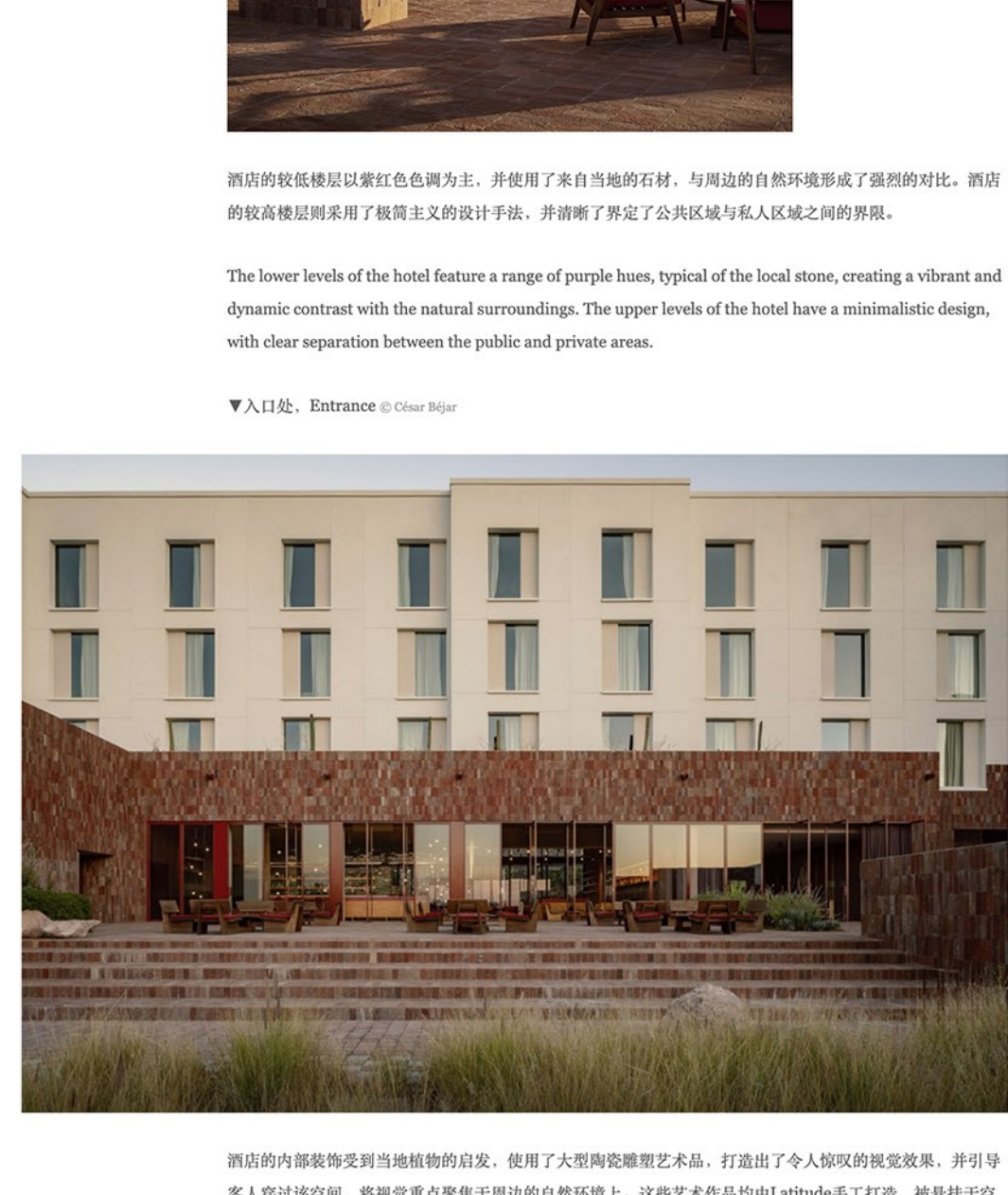

▼建筑采用当地的石材，The use of local stone © Clear Bijker

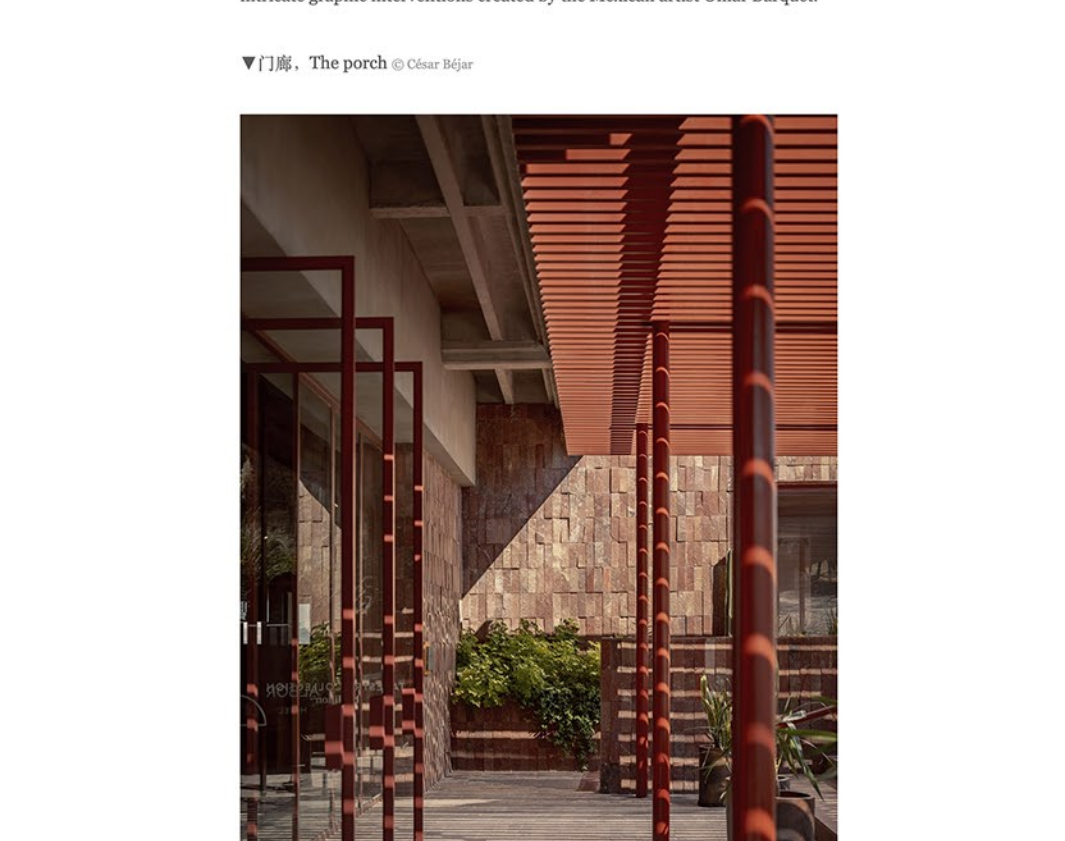

▼入口处，Entrance © Clear Bijker



▼从入口处看向酒店大堂，View from the entrance to the hotel lobby © Clear Bijker

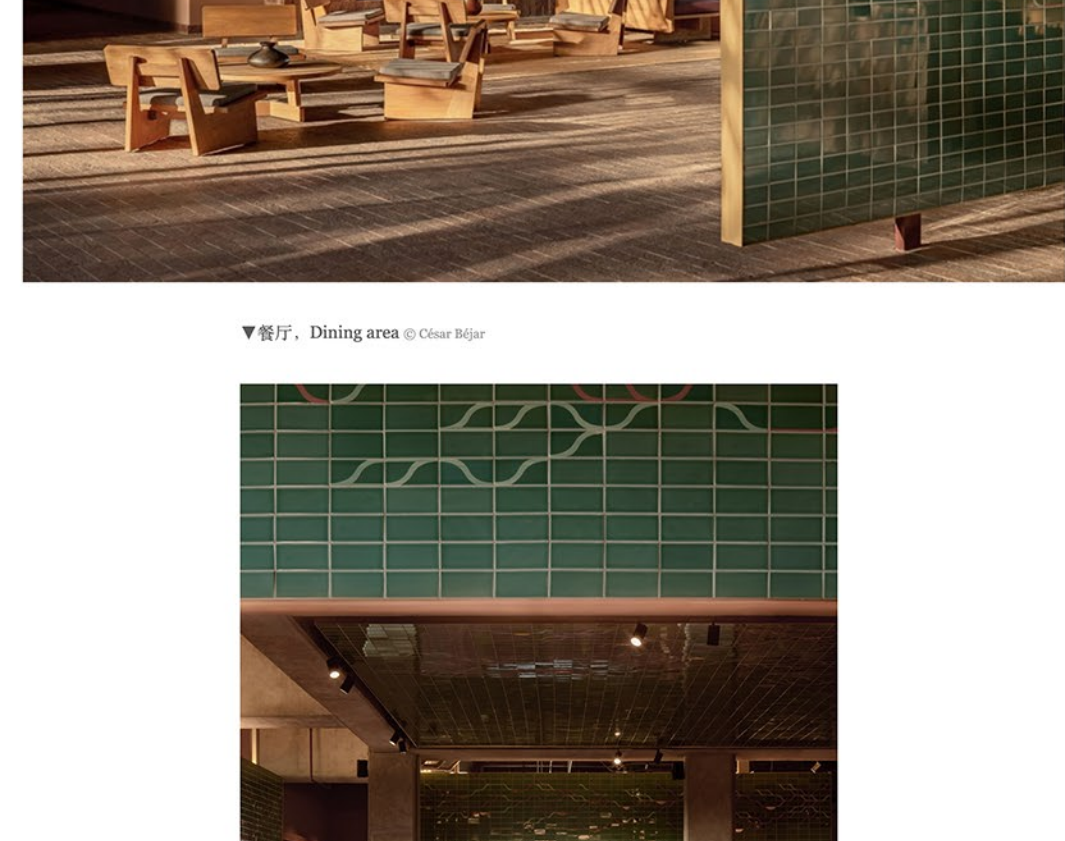

▼大堂轻松的氛围，Relaxed atmosphere in the lobby © Clear Bijker

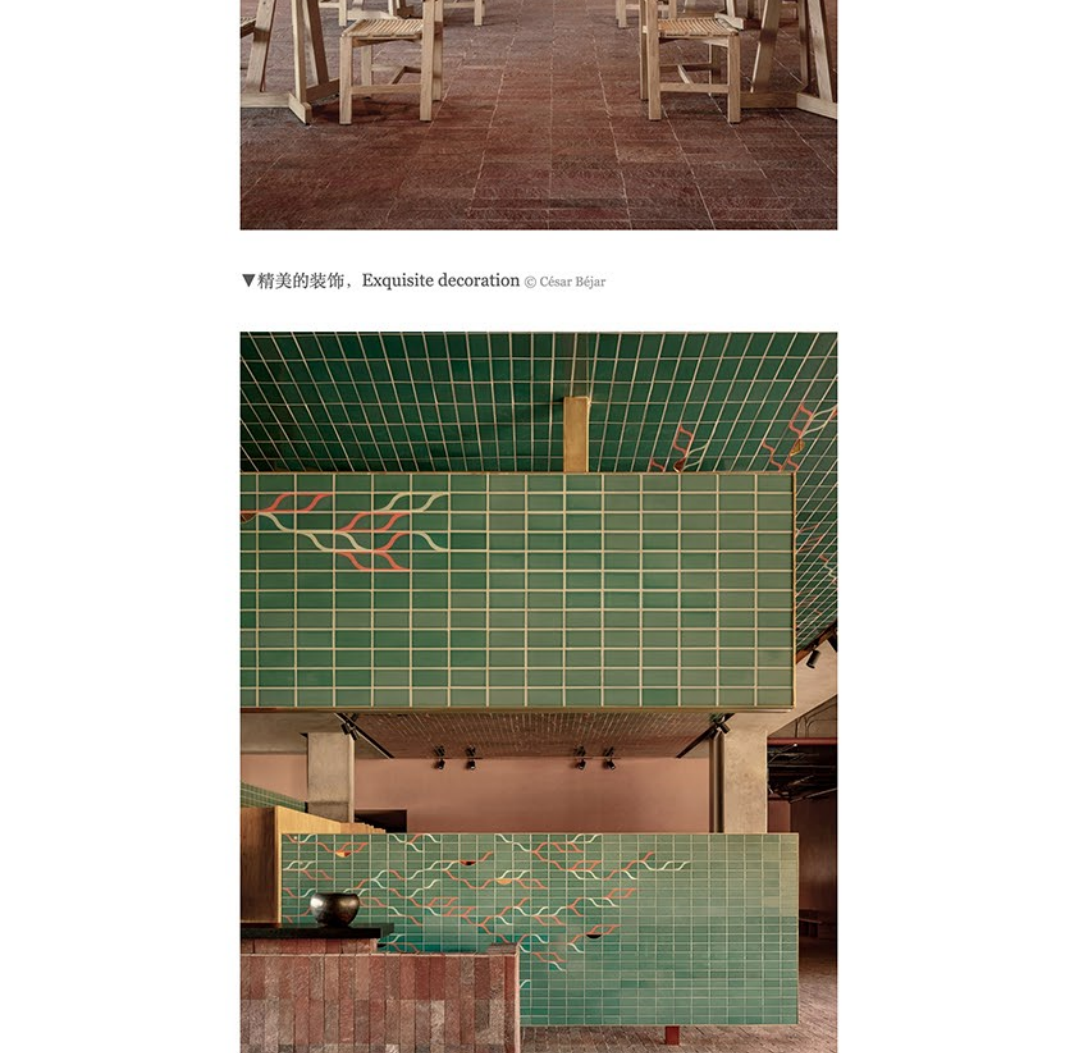

▼餐厅，Dining area © Clear Bijker

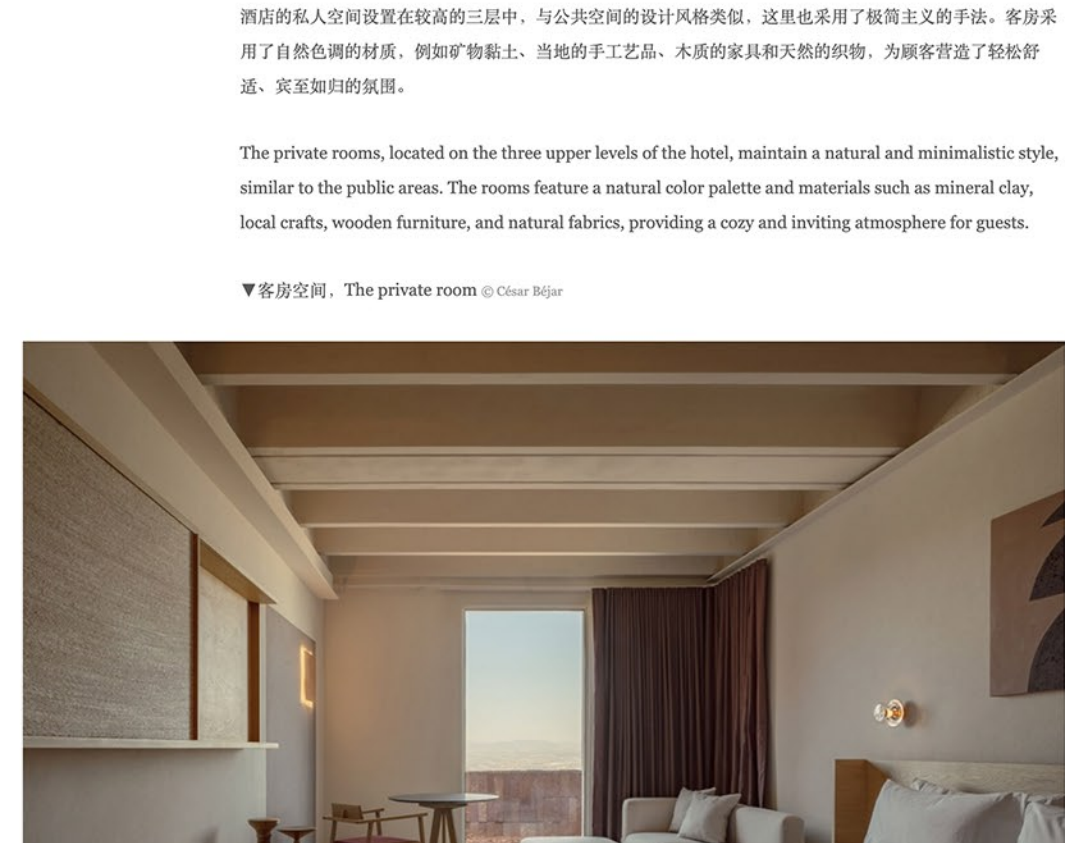

▼精美的装饰，Exquisite decoration © Clear Bijker

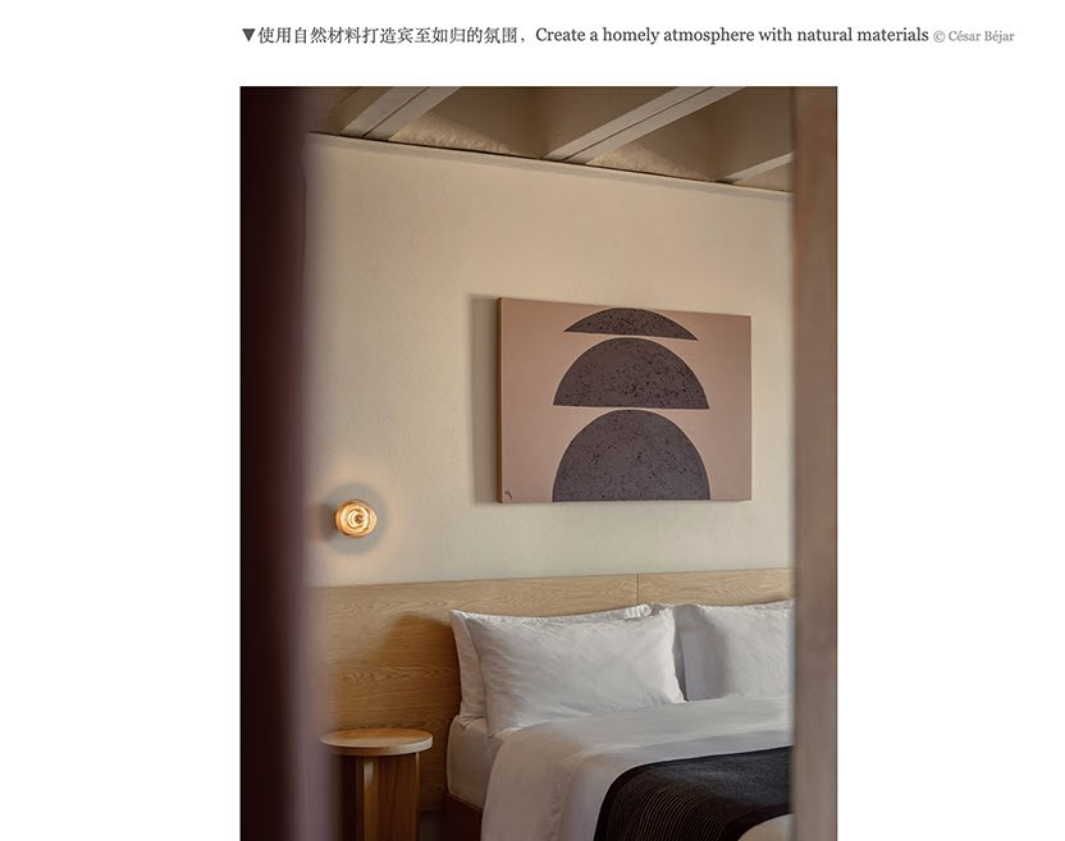

▼客房空间，The private room © Clear Bijker



▼使用自然材料打造宾至如归的氛围，Create a homely atmosphere with natural materials © Clear Bijker

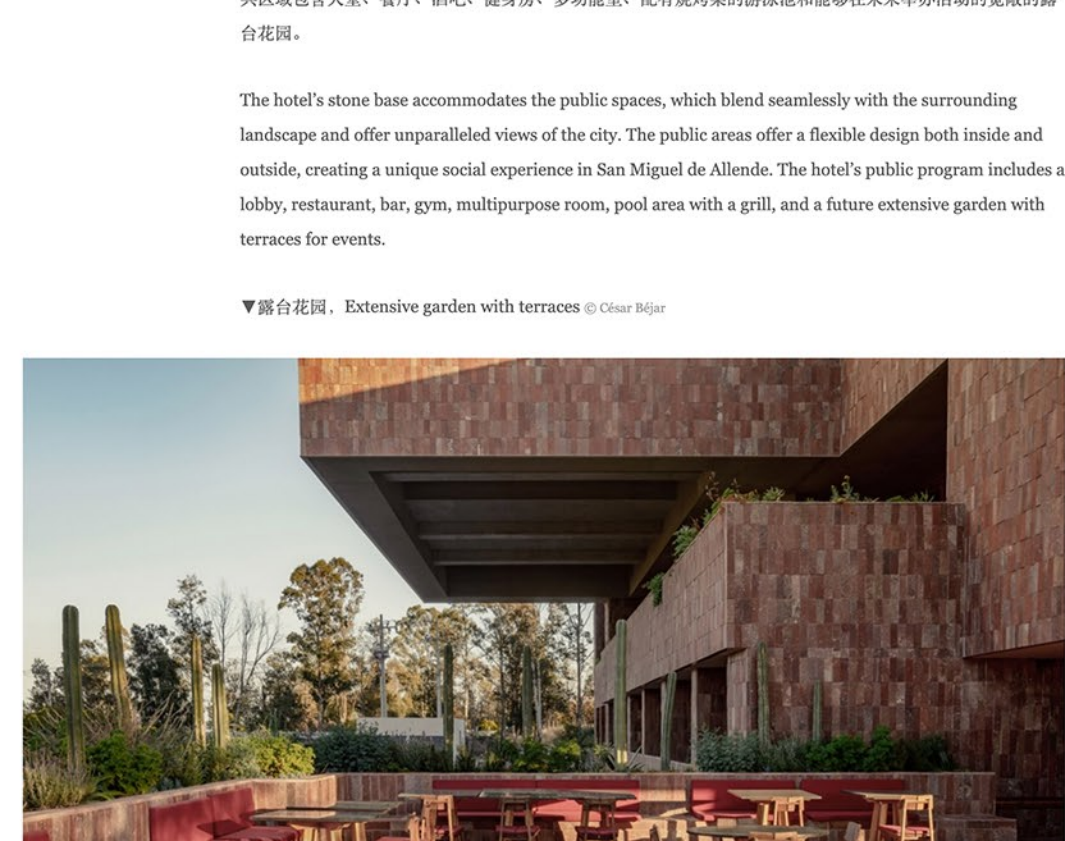

▼客房卫生间，Toilet © Clear Bijker

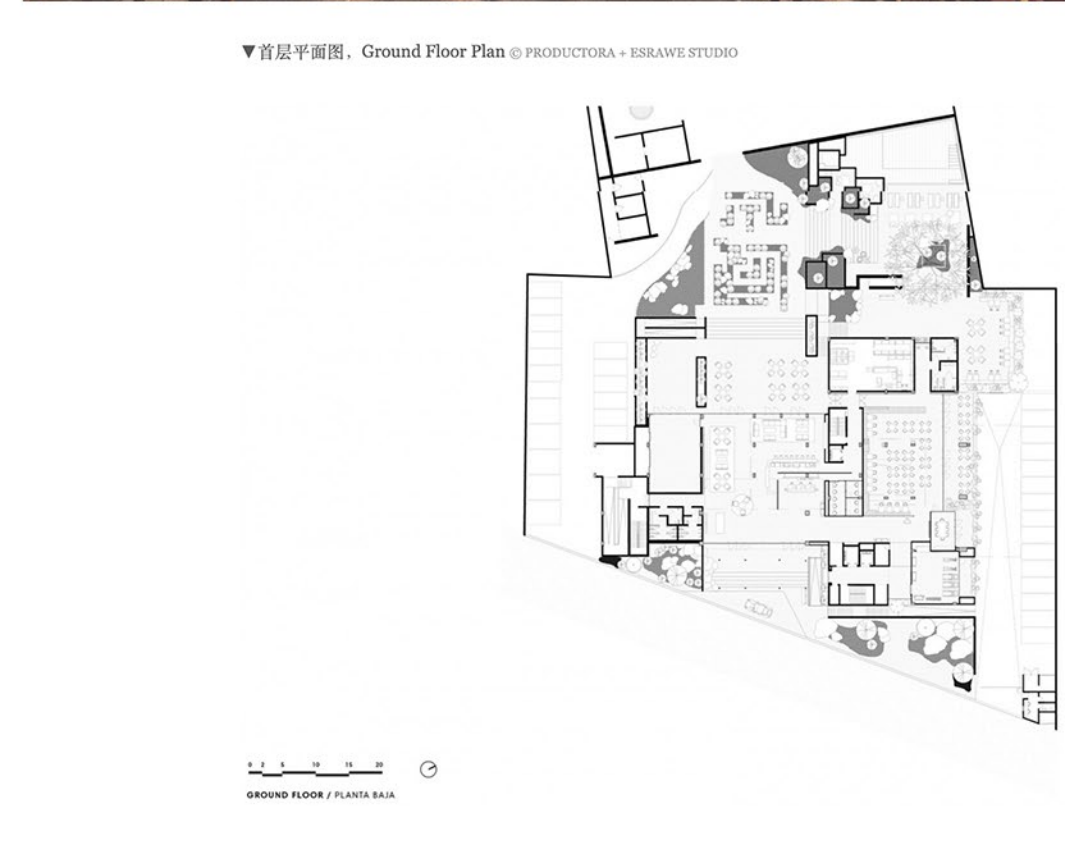

▼露台花园，Extensive garden with terraces © Clear Bijker

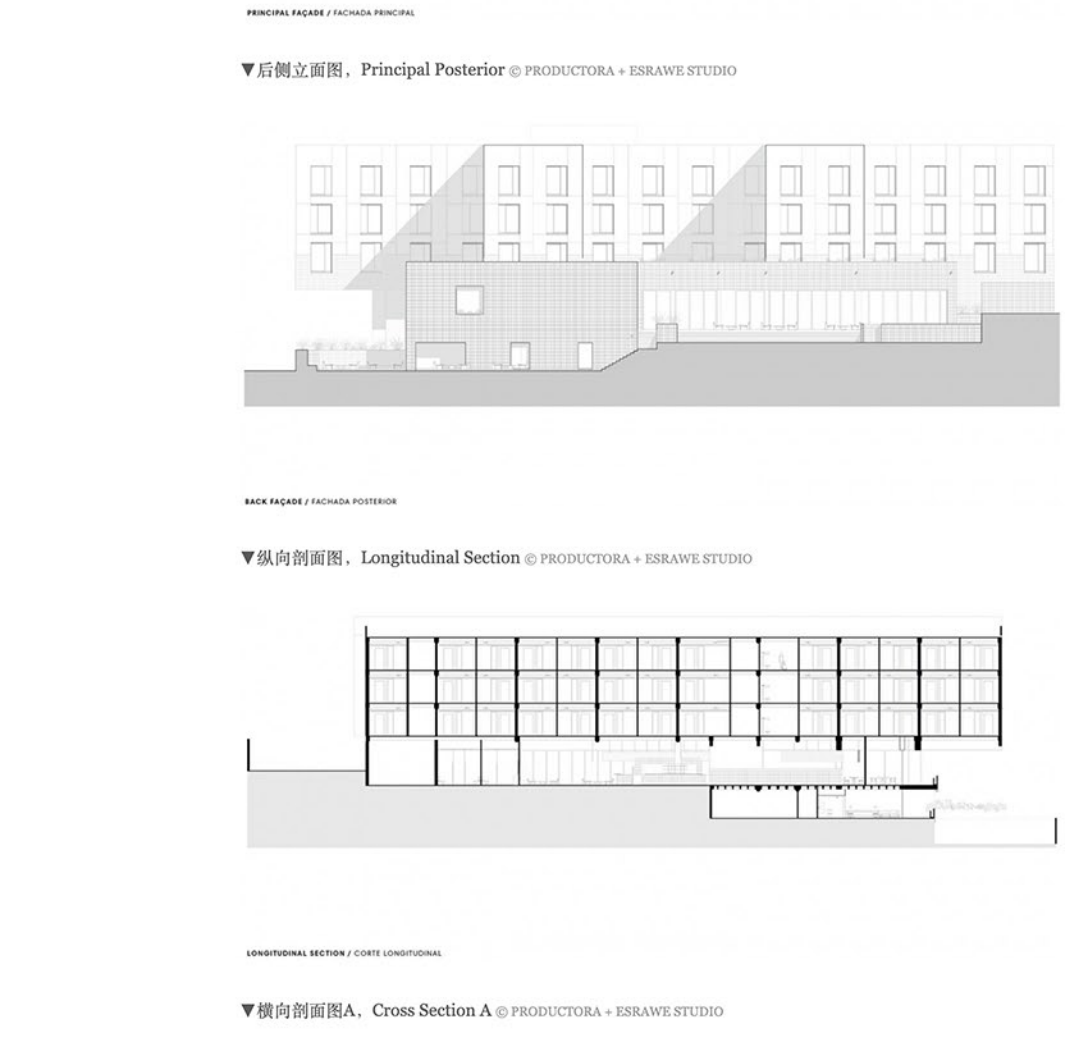

▼首层平面图，Ground Floor Plan © PRODUCTORA + ESRawe STUDIO

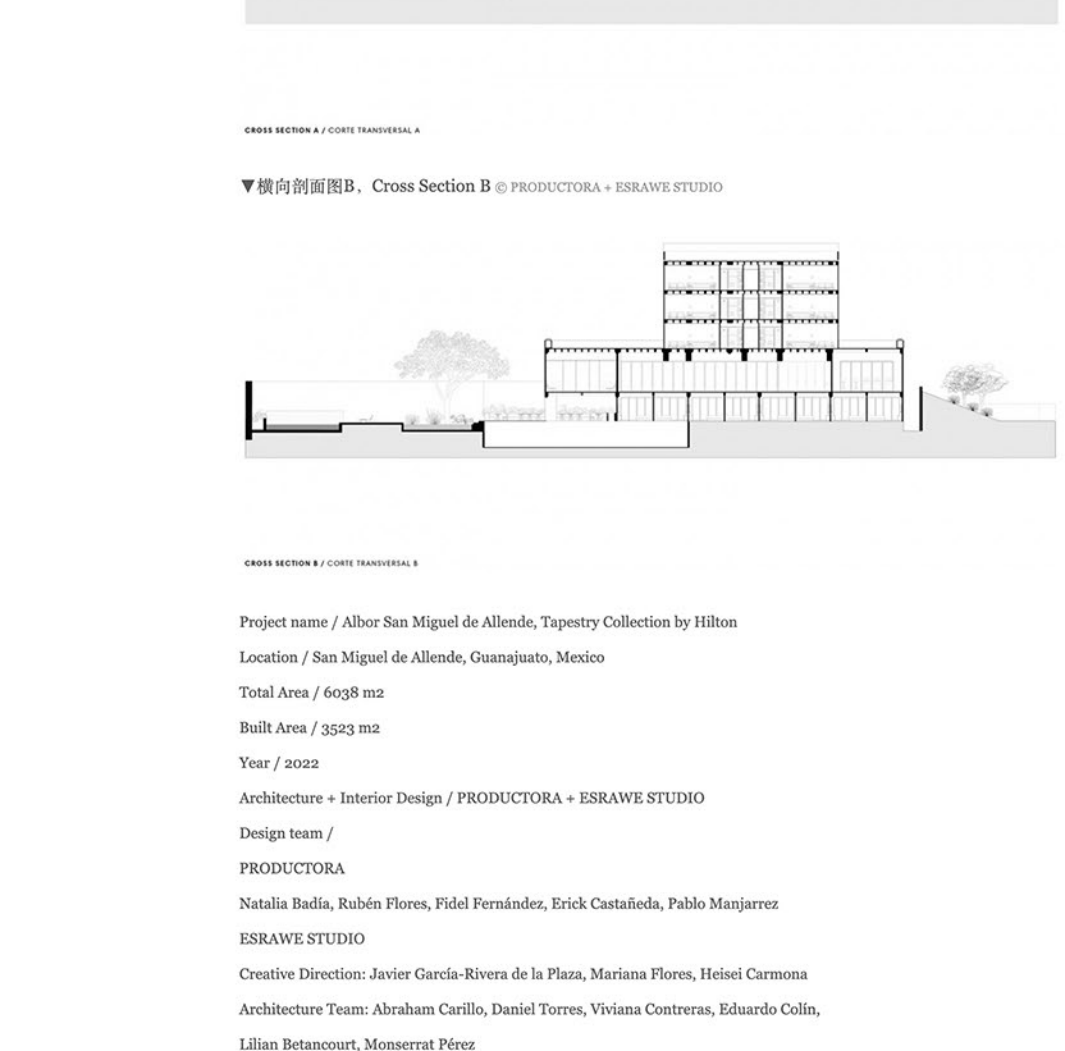

▼主要立面图，Principal Facade © PRODUCTORA + ESRawe STUDIO

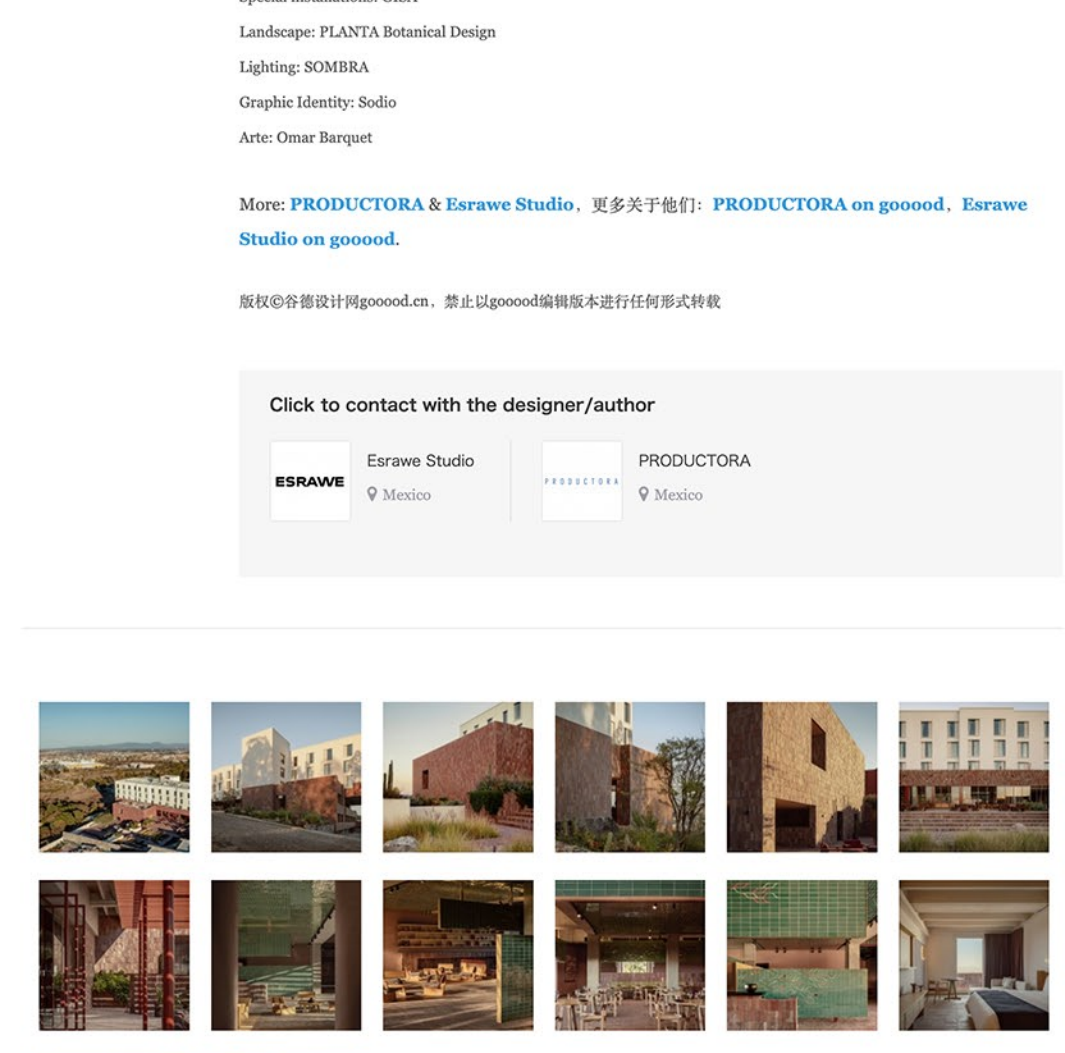

▼后侧立面图，Principal Posterior © PRODUCTORA + ESRawe STUDIO

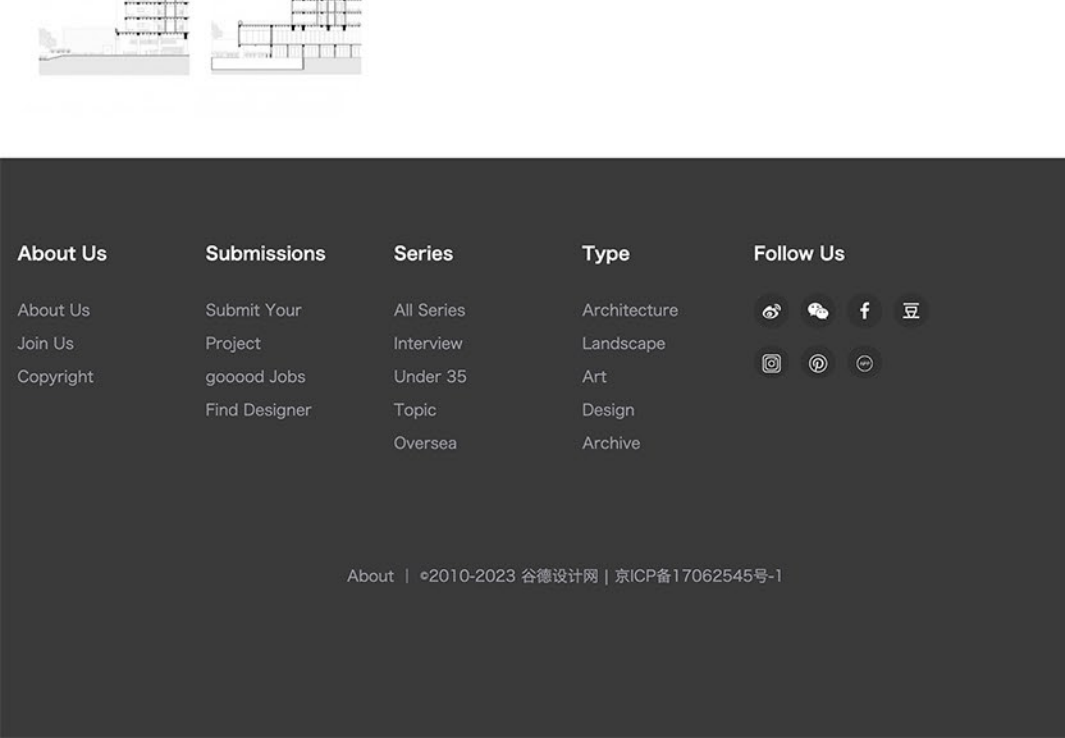

▼纵向剖面图，Longitudinal Section © PRODUCTORA + ESRawe STUDIO

▼横向剖面图A，Cross Section A © PRODUCTORA + ESRawe STUDIO

▼横向剖面图B，Cross Section B © PRODUCTORA + ESRawe STUDIO

Project name / Albor San Miguel de Allende, Tapestry Collection by Hilton
 Location / San Miguel de Allende, Guanajuato, Mexico
 Total Area / 6038 m²
 Built Area / 2523 m²
 Year / 2022
 Architecture + Interior Design / PRODUCTORA + ESRawe STUDIO
 Design team / PRODUCTORA
 Natalia Badía, Rubén Flores, Fidel Fernández, Erick Castañeda, Pablo Manjarrez
 ESRawe STUDIO
 Creative Direction: Javier García-Rivera de la Plaza, Mariana Flores, Helene Garmana
 Architecture Team: Abraham Carillo, Daniel Torres, Viviana Contreras, Eduardo Collin,
 Elián Betancourt, Monserat Pérez
 Furniture Design: Roberto González
 Renderings: Yair Ugarte
 External Advisors /
 Project consultants: Hilton Cala Team
 MEP Installations: GISA
 Special Installations: GISA
 Landscape: PLANTA Botanical Design
 Lighting: SOMBRA
 Graphic Identity: Sodio
 Arts: Omar Barquet

More: [PRODUCTORA & ESRawe Studio](#). 更多关于他们: [PRODUCTORA on goodoo](#), [ESRawe Studio on goodoo](#).

版权©设计网goodoo.cn，禁止以goodoo链接形式进行任何形式转载

Click to contact with the designer/author

ESRawe ESRawe Studio Mexico

PRODUCTORA PRODUCTORA Mexico

